

Padding Upgrade Options

WPUP3N

Upgrade any 2" neoprene foam wall padding to 3" neoprene foam for added player protection or to meet local codes or project specifications.

WPUPFRC

Upgrade any wood backed wall padding to add a fire retardant coating to the 7/16" OSB backing to meet local codes or project specifications.

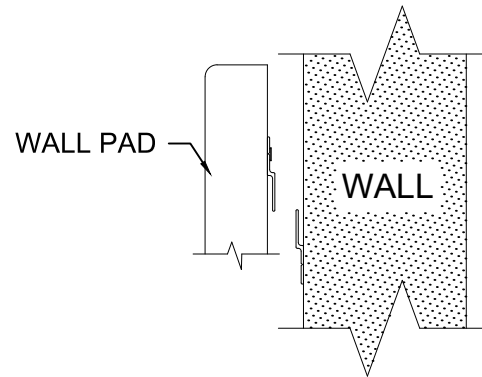
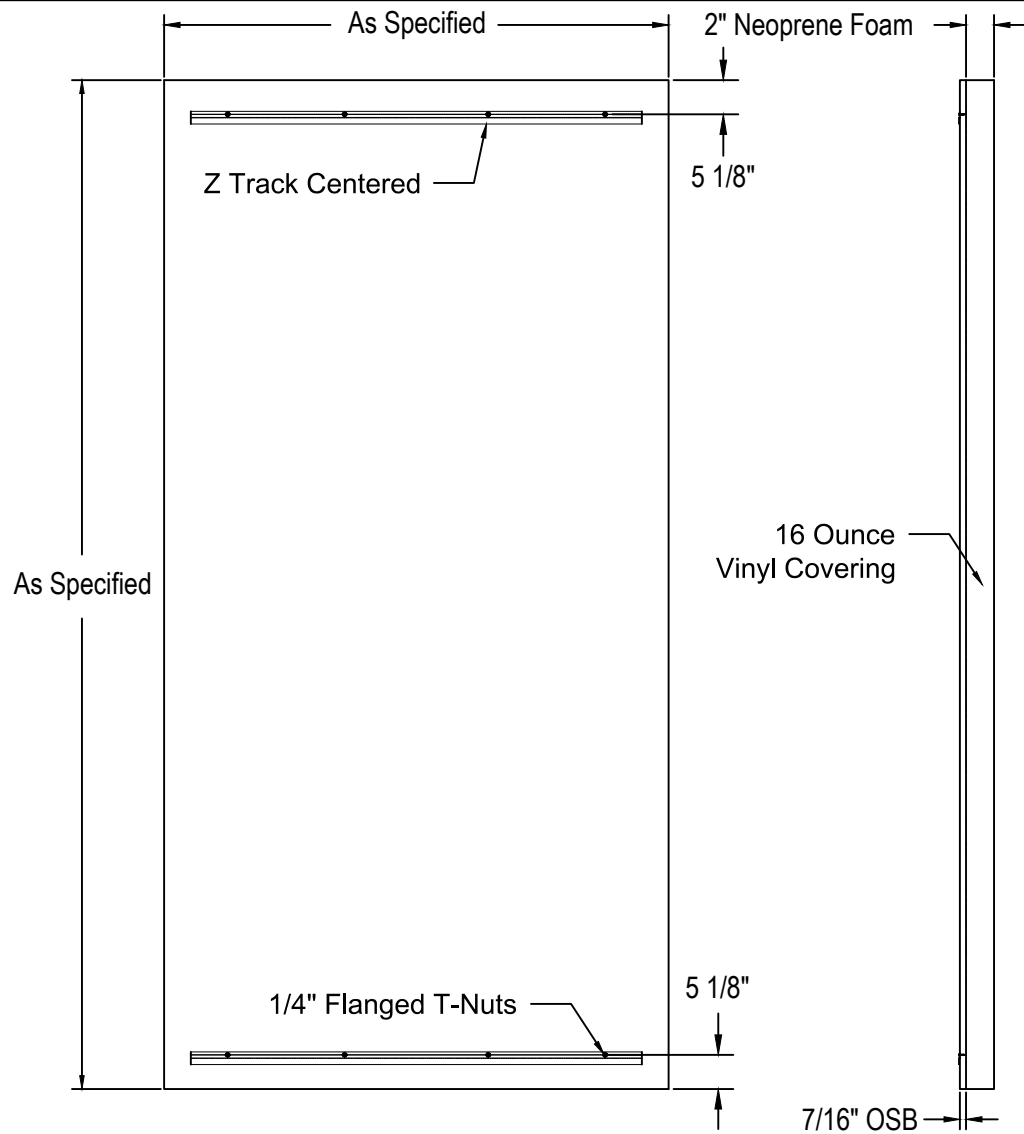

Firewall™ Wall Padding Specifications

Full color graphic Firewall padding including custom corner, column, door and stage padding is constructed of neoprene foam with Indentation Load Deflection (ILD) of 25-45 pounds, 2" thickness at 25% deflection per ASTM D3574 Test B1 and a density of 6.2 pounds per cubic foot per ASTM D3574 Test A. Firewall neoprene foam passes California Fire Code TIB 117:2013. 16 ounce vinyl covering has a ASTM D2261 tear strength of 92 x 83 pounds per inch and has been treated for mildew and UV protection. Vinyl conforms to NFPA-701 CSFM and Class A ASTM E-84. Wood backed padding is mounted on 7/16" OSB composite board with the foam attached to the OSB with water based adhesive. Assembled padding has been tested and meets NFPA 286.



PRODUCT SPECIFICATION: WP2NGZW

FIREWALL GRAPHIC HIDDEN Z TRACK WALL PADDING

REVISED 07/02/19